

# Fly case

DAY UNITS

A refined and original composition where the symmetry of the elements combines with the irregularity of the giraffe embroideries, which characterize the leather doors. Flycase sideboard belongs to the "flycase" series, inspired by the protective containers used for the transport of fragile tools and it's a functional and dynamic solution with a strong contemporary and decorative appeal.



# Fly case

## DAY UNITS

Structure in multilayer wood covered with leathers from the collection or in oak col. glossy wengé. Metal details available in all the finishings from the collection. Optional hexagonal, lozenge or Uma quilted leather.

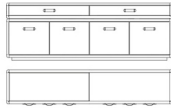

FLY.113.A

Sideboard 4 doors + 2 drawers

Standard features

L 247 D 50 H 84 cm  
L 97.24 D 19.69 H 33.07 in

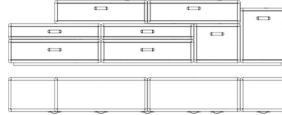

FLY.113.B

Sideboard with doors and drawers - right

Standard features

L 410 D 50 H 95 cm  
L 161.42 D 19.69 H 37.4 in

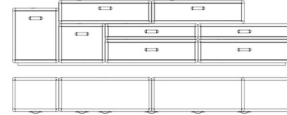

FLY.113.C

Sideboard with doors and drawers - left

Standard features

L 410 D 50 H 95 cm  
L 161.42 D 19.69 H 37.4 in

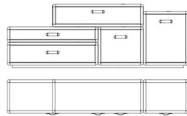

FLY.113.F

Sideboard with doors and drawers - right

Standard features

L 272 D 50 H 95 cm  
L 107.09 D 19.69 H 37.4 in

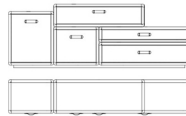

FLY.113.G

Sideboard with doors and drawers - left

Standard features

L 272 D 50 H 95 cm  
L 107.09 D 19.69 H 37.4 in

# Fly case

---

DAY UNITS

---

## UPHOLSTERY

---

Leather cat. A  
Leather cat. B  
Leather cat. C Cavallino  
Eco-turtle

See the detailed files in the "Technical information" section

# Fly case

DAY UNITS

## STRUCTURE

### Metal



Black chrome



Brushed gold



Brushed  
bronze



Brushed dark  
bronze



Gold

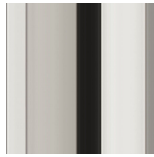

Chrome

# Fly case

DAY UNITS

## OPTIONALS UPHOLSTERY

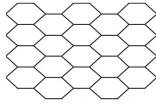

Hexagonal  
quilted  
leather - only  
front

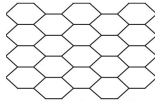

Hexagonal  
quilted  
leather - only  
structure



Lozenge  
quilted  
leather - only  
front



Lozenge  
quilted  
leather - only  
structure