

Grandtour

NIGHT UNITS



Grandtour

NIGHT UNITS

Structure in multilayer wood. Outer part available in all the leathers from the collection. Inside available in all the silk from the collection. Metal details available in all the finishings from the collection. "Jewel handle" in melted brass available in platinum or golden finishing. Optional hexagonal or lozenge quilted leather. Stool cm 52,5 x 34 x h 52 included.

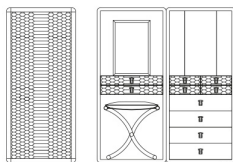

GRA.361.A

Travel wardrobe

Standard features

L 80 D 65 H 150 cm

L 31.5 D 25.59 H 59.06 in

Grandtour

NIGHT UNITS

UPHOLSTERY

Leather cat. A

Leather cat. B

See the detailed files in the "Technical information" section

Grandtour

NIGHT UNITS

STRUCTURE

Metal



Black chrome



Brushed gold



Brushed
bronze



Brushed dark
bronze



Gold



Chrome

Grandtour

NIGHT UNITS

OPTIONALS UPHOLSTERY

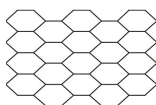

Hexagonal
quilted
leather - only
selected ones

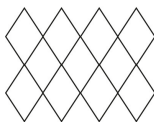

Lozenge
quilted
leather - only
selected ones